



21 Windmill Drive, Croxley Green, WD3 3FF  
Price Guide £815,000



4



2



2



C



Floor Plan

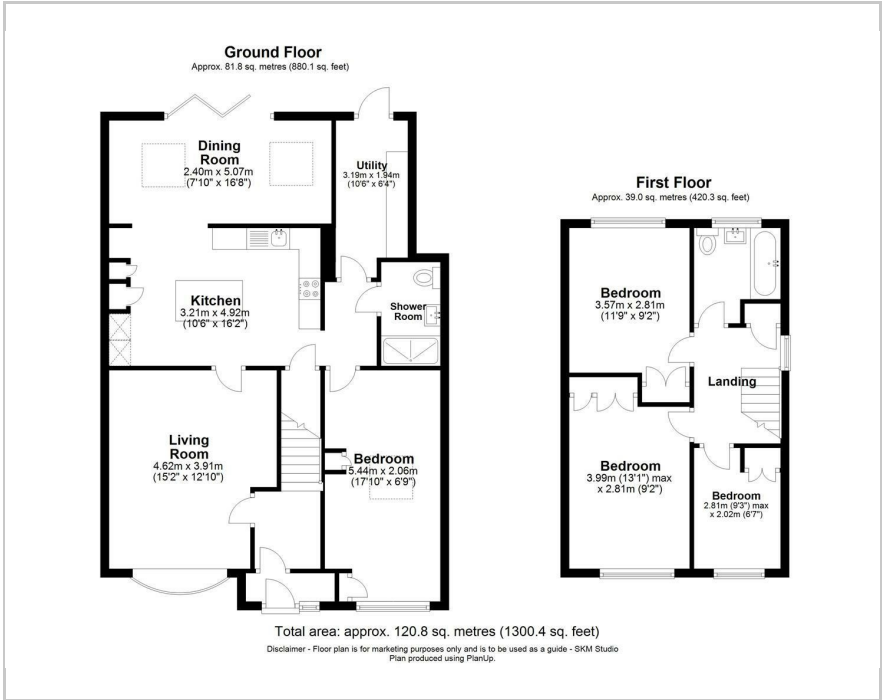

Area Map



Accommodation

- Beautifully presented 4 bed link detached extended home
- Catchment area for Rickmansworth Senior school
- Bedroom and En-Suite downstairs
- Open plan kitchen/dining room
- Separate front reception room
- Utility area
- Pretty rear garden
- Quiet residential area

Viewing

Please contact our Grosvenor Estate Agents Ltd Office on 01923 711651 if you wish to arrange a viewing appointment for this property or require further information.

Energy Efficiency Graph

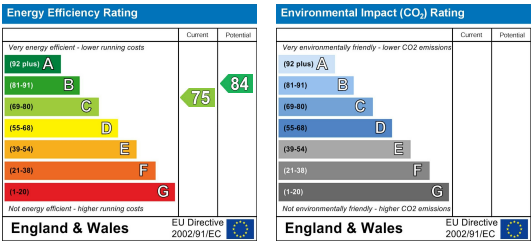

These particulars, whilst believed to be accurate are set out as a general outline only for guidance and do not constitute any part of an offer or contract. Intending purchasers should not rely on them as statements of representation of fact, but must satisfy themselves by inspection or otherwise as to their accuracy. No person in this firms employment has the authority to make or give any representation or warranty in respect of the property.